

POWERBLOCK POWERSTAND ASSEMBLY STEP ONE

ITEM NO.	DESCRIPTION	QTY.
1	POWERSTAND SPACER SUPPORT	1
2	POWERSTAND LEFT LEG	1
3	POWERSTAND RIGHT LEG	1
4	M10 - 1.5mm X 50mm BUTTON HEAD SCREW	4
5	M10 WASHER	8
6	M10 - 1.5mm LOCK NUT	4

TOOLS NEEDED: ONE 17mm WRENCH AND ONE 6mm HEX ALLEN WRENCH.

1. ATTACH LEFT LEG (ITEM 2) TO SPACER SUPPORT (ITEM 1) WITH SUPPLIED HARDWARE.
DO NOT TIGHTEN HARDWARE.
2. ATTACH RIGHT LEG (ITEM 3) TO SPACER SUPPORT (ITEM 1) WITH SUPPLIED HARDWARE.

TIGHTEN ALL HARDWARE.

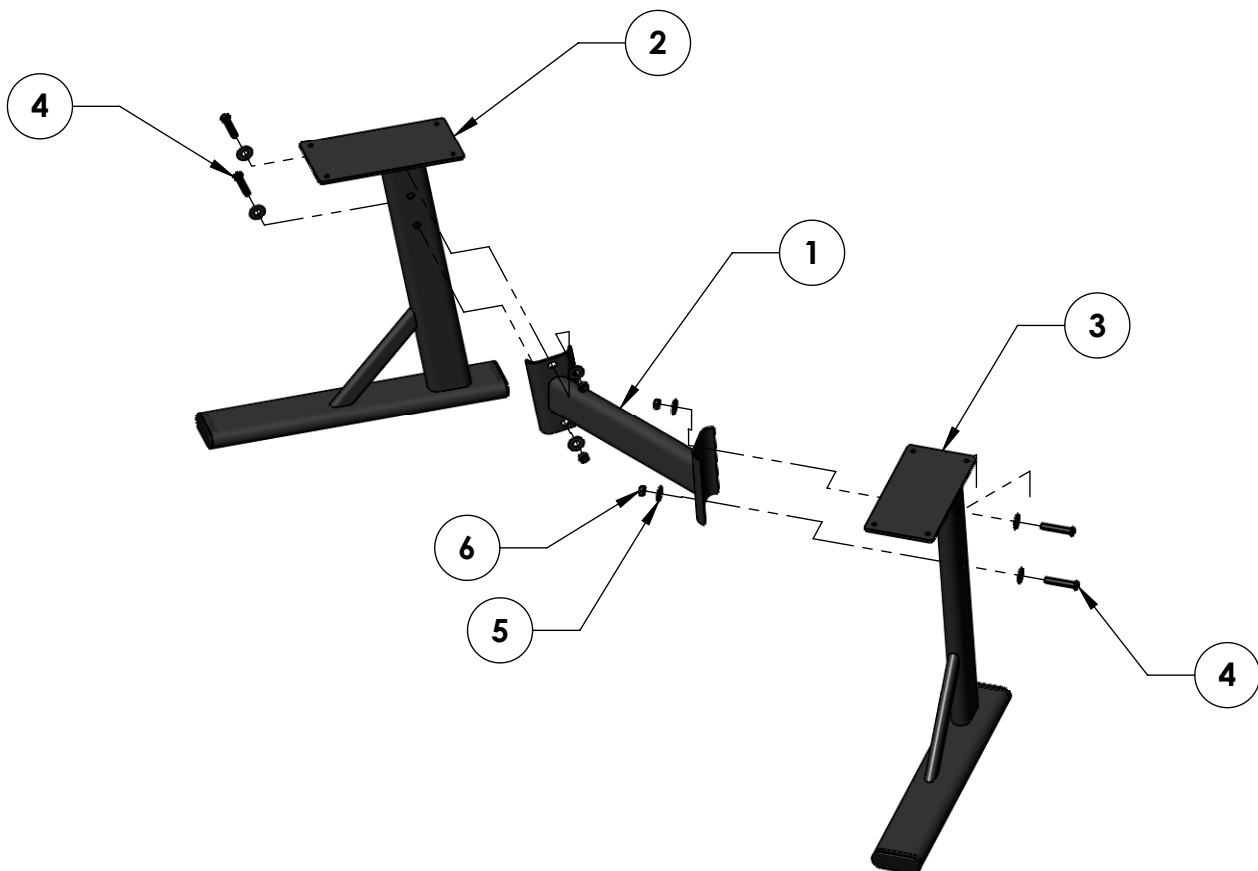

POWERBLOCK POWERSTAND ASSEMBLY STEP TWO

ITEM NO.	DESCRIPTION	QTY.
1	POWERSTAND LEG ASSEMBLY	1
2	POWERSTAND TOP	2
3	M5 - .8mm LOCK NUT	8
4	POWERSTAND TRAY MAT	2

TOOLS NEEDED: ONE 8mm WRENCH.

1. ATTACH BOTH TOPS (ITEM 2) TO LEG ASSEMBLY (ITEM 1) WITH SUPPLIED HARDWARE. TIGHTEN HARDWARE.
2. APPLY TRAY MATS (ITEM 4) TO TOPS (ITEM 2).

TIGHTEN ALL HARDWARE.

